

THREAD SHAPING SCREWS FOR THERMOPLASTIC MATERIALS.

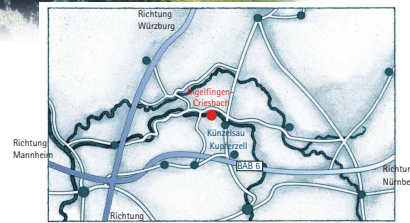

	Nominal diam. - e	R 30	R 35	R 40	R 50	R 60	R 70	
Thread - External - e	d min.	3,00	3,50	4,00	5,00	6,00	7,00	
	d max.	3,14	3,68	4,18	5,18	6,22	7,22	
Thread - Pilot - e	d 2 min.	1,80	1,95	2,30	2,95	3,50	4,10	
	d 2 max.	1,94	2,13	2,48	3,13	3,72	4,32	
Thread - Pitch	p	1,50	1,75	2,00	2,40	2,85	3,60	
Head-Diameter	D a	6,00	7,00	8,00	10,00	12,00	14,00	
Head-Height	k	2,10	2,40	2,50	3,20	4,00	4,60	
Washer thickness	c	0,75	0,85	0,95	1,20	1,40	1,60	
PH Width / Size	m	2,8 / 1	3,8 / 2	4,2 / 2	4,7 / 2	6,3 / 3	7,0 / 3	
	Depth	t min.	1,28	1,08	1,40	2,01	2,27	2,91
	t max.	1,51	1,54	1,86	2,47	2,73	3,37	
RN 0037	PH Width / Size	m	2,90 / 1	3,00 / 2	4,10 / 2	4,60 / 2	6,40 / 3	6,80 / 3
	Depth	t min.	1,15	1,25	1,50	2,11	2,34	2,95
	t max.	1,60	1,70	1,98	2,62	2,90	3,53	
RN 0038	TZD Width / Size	A / Size	2,82 / S 10	2,82 / S 10	3,94 / S 20	4,52 / S 25	5,61 / S 30	
	Depth	t min.	1,01	1,52	1,42	1,52	2,28	2,28
	t max.	1,27	1,78	1,8	1,91	2,6	2,67	
RN 0039	Head-Diameter	D	5,60	6,50	7,50	8,80	10,80	12,30
	Head-Height	k	2,20	2,55	2,75	3,40	4,10	4,60
RN 0044	PH Width / Size	m	3,00 / 1	4,00 / 2	4,40 / 2	4,90 / 2	6,40 / 3	6,80 / 3
	Depth	t min.	1,40	1,40	1,80	2,15	2,50	3,02
	t max.	1,80	1,90	2,40	2,75	3,10	3,62	
RN 0046	PH Width / Size	m	3,00 / 1	3,90 / 2	4,40 / 2	4,90 / 2	6,40 / 3	6,80 / 3
	Depth	t min.	1,40	1,40	1,90	2,15	2,50	3,02
	t max.	1,80	1,90	2,40	2,75	3,10	3,62	
RN 0048	TZD Width / Size	A / Size	2,82 / S 10	2,82 / S 10	3,94 / S 20	4,52 / S 25	5,61 / S 30	
	Depth	t min.	1,01	1,14	1,27	1,39	1,9	2,28
	t max.	1,27	1,4	1,66	1,78	2,29	2,67	
RN 0052	Head-Diameter	D	5,50	7,30	8,40	9,30	11,30	12,50
	Head-Height	k	1,45	2,15	2,45	2,45	2,95	3,15
RN 0055	PH Width / Size	m	2,80 / 1	4,00 / 2	4,20 / 2	4,40 / 2	6,60 / 3	6,80 / 3
	Depth	t min.	1,48	1,60	1,85	2,05	2,99	2,99
	t max.	1,73	2,06	2,31	2,51	3,45	3,46	
RN 0053	PH Width / Size	m	3,00 / 1	4,20 / 2	4,40 / 2	4,60 / 2	6,20 / 3	6,80 / 3
	Depth	t min.	1,40	1,62	1,90	2,11	2,31	2,95
	t max.	1,70	2,12	2,40	2,62	2,81	3,53	
RN 0054	TZD Width / Size	A / Size	2,82 / S 10	2,82 / S 10	3,94 / S 20	4,52 / S 25	5,61 / S 30	
	Depth	t min.	0,84	1,14	1,27	1,52	2,28	2,28
	t max.	1,10	1,40	1,66	1,91	2,60	2,68	
RN 0059	Head-Diameter	D	5,50	7,30	8,40	9,30	11,30	12,50
	Head-Height	k	1,45	2,15	2,45	2,45	2,95	3,15
RN 0060	PH Width / Size	m	3,00 / 1	4,20 / 2	4,40 / 2	4,60 / 2	6,40 / 3	6,80 / 3
	Depth	t min.	1,40	1,60	1,90	2,15	2,50	3,00
	t max.	1,80	2,10	2,40	2,75	3,10	3,60	
RN 0061	TZD Width / Size	A / Size	2,82 / S 10	2,82 / S 10	3,94 / S 20	4,52 / S 25	5,61 / S 30	
	Depth	t min.	1,01	1,52	1,52	1,9	2,28	2,66
	t max.	1,27	1,78	1,91	2,29	2,67	3,05	
RN 0070	Max size	SW	5,00	5,50	7,00	8,00	10,00	10,00
	Head height	k	1,50	2,40	2,40	3,10	3,80	4,20
Socket-dimension	e	5,4	5,96	7,59	8,71	10,95	10,95	



RSF-REISSER-SCHRAUBENFERTIGUNG
 Fritz-Müller-Str. 12
 D-74653 Ingelfingen-Criesbach
 Tel. +49 (0)7940/127-154
 Fax +49 (0)7940/127-123
 E-Mail:produktion@reisser-screws.com
 Ein Unternehmen der REISSER-SCHRAUBENTECHNIK GmbH

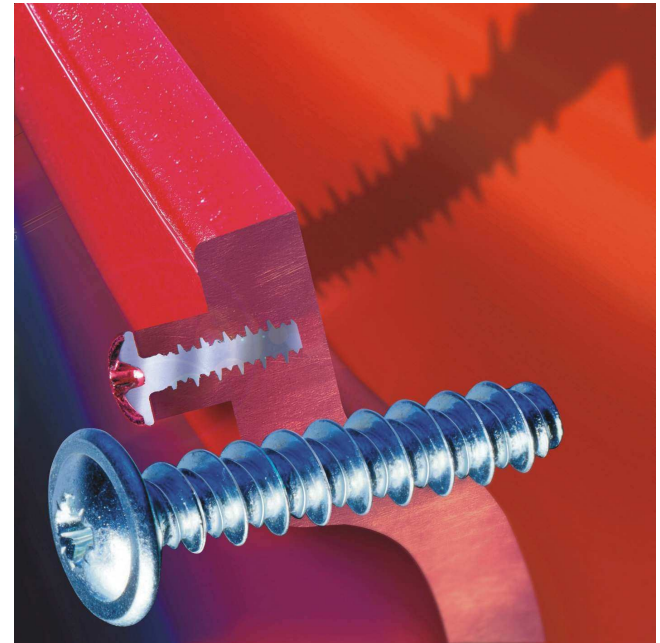

RSF-Projekt-L3000-MW-5-D-Auflage 1000



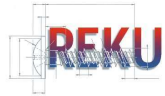

SCREWS

thread shaping screws for thermoplastic materials.

Material:
Case hardened steel, steel, 8.8, 10.9, stainless steel A2, A4
Ask for other materials.

Surface:
Steel zinc plated (blue, yellow, black)
Ruspert, Delta-Seal, Delta-Tone
Ask for other surfaces.



Technical details:

- 25° thread angle
Because of a 25° thread angle less force for screw-in is necessary.
- Asymmetric thread flanks
Higher torque and pull out results with low screw-in torque caused by asymmetric thread flanks.
- Guide thread
A Guide thread between the asymmetric thread flanks guarantees better raising of the screw and prevents tilt.
- Higher thread pitch
Combination of asymmetric thread flanks and leading thread facilitate a pitch of 10%.

Nominal Length	Ø 3	Ø 3.5	Ø 4	Ø 5	Ø 6	Ø 7	Ø 8	Ø 10
8 + 0,75								
10 + 0,75								
12 + 0,90								
14 + 0,90								
16 + 0,90								
18 + 0,90								
20 + 1,05								
25 + 1,05								
30 + 1,05								
35 + 1,25								
40 + 1,25								
45 + 1,25								
50 + 1,25								
60 + 1,50								
70 + 1,50								
80 + 1,50								
90 + 1,50								
100 + 1,50								
110 + 1,50								
120 + 1,50								
130 + 1,50								
140 + 1,50								
150 + 1,50								

Special parts are available on request

Top stepped line
= Minimum standard lengths

Lower stepped line
= Maximum standard lengths
Special lengths
only available on request!
With full and partial thread.

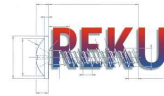

RN 0037 = Pan head with pressed washer PZ
RN 0038 = Pan head with pressed washer PH
RN 0039 = Pan head with pressed washer TZD

RN 0044 = Pan Head PZ
RN 0046 = Pan Head PH
RN 0048 = Pan Head TZD

RN 0052 = Flat countersunk head PZ
RN 0053 = Flat countersunk head PH
RN 0054 = Flat countersunk head TZD

RN 0059 = Pan head countersunk head PZ
RN 0060 = Pan head countersunk head PH
RN 0061 = Pan head countersunk head TZD

RN 0070 = Hexagonal screw

Further screw head forms available on request.

Order example:
RN 0037 4,0 x 25 10.9 hardened and tempered, blue galvanized.

Types of drive

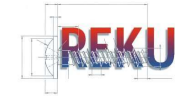
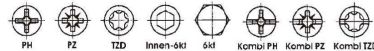

Insertion recommendations

Guidelines for selection of pilot hole diameter

Multiply the smallest outer diameter of the screw with the factor in the column "Screw-Ø d_s" in order to find the approximate pilot hole diameter for the material in the "Material" column.

Design recommendation for dome with REKU screws

Material	Hole - ø d _s	External ø B	Insertion depth T
ABS	0,80 x d	2,00 x d	2,00 x d
ABS / PC Blend	0,80 x d	2,00 x d	2,00 x d
ASA	0,78 x d	2,00 x d	2,00 x d
PA 4.6	0,73 x d	1,85 x d	1,80 x d
PA 4.6 - GF 30	0,78 x d	1,85 x d	1,80 x d
PA 6	0,75 x d	1,85 x d	1,70 x d
PA 6 - GF 30	0,80 x d	2,00 x d	1,90 x d
PA 6.6	0,75 x d	1,85 x d	1,70 x d
PA 6.6 - GF 30	0,82 x d	2,00 x d	1,80 x d
PBT	0,75 x d	1,85 x d	1,70 x d
PBT - GF 30	0,80 x d	1,80 x d	1,70 x d
PC	0,85 x d	2,50 x d	2,20 x d
PC - GF 30	0,85 x d	2,20 x d	2,00 x d
PE (weich)	0,70 x d	2,00 x d	2,00 x d
PE (hart)	0,75 x d	1,80 x d	1,80 x d
PET	0,75 x d	1,85 x d	1,70 x d
PET - GF 30	0,80 x d	1,80 x d	1,70 x d
PMMA	0,85 x d	2,00 x d	2,00 x d
POM	0,75 x d	1,95 x d	2,00 x d
PP	0,70 x d	2,00 x d	2,00 x d
PP - TV 20	0,72 x d	2,00 x d	2,00 x d
PPO	0,85 x d	2,50 x d	2,20 x d
PS	0,80 x d	2,00 x d	2,00 x d
PVC (hart)	0,80 x d	2,00 x d	2,00 x d

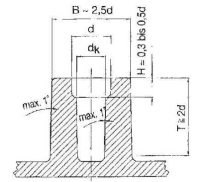

D=Nominal diameter of screw
Pilot hole diameter D_p according to Table

The values given are for guidance purposes only.

We recommend that you have your components tested in our factory with regard to insertion torque, tightening torque, overtorque an insertion depth.

The correct parameters for your screw application can only be accurately determined with individual trials and assessments.