

## Facade screw type BZ Stainless steel A2 FABA-BZ-6,3 x L E16

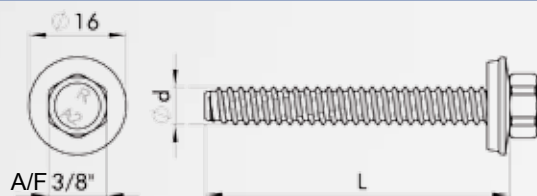

- Pre-drilling according to pre-drill table on page 73
- With technical approval
- Zinc-slide coating
- With captive sealing washer stainless steel A2/EPDM
- For steel substructure 1,25 mm and aluminium 1,5 mm

Designation	Ø d x L mm	Washer EPDM Ø	Grip thickness mm	EAN Item No.	Pack
FABA-BZ-	6,3 x 19	E16	9	4005674 42501 8 000332V020-0630196-1	500
	6,3 x 19	E16	9	4005674 53146 7 000332V020-0630192-1	100
	6,3 x 25	E16	15	4005674 42502 5 000332V020-0630256-1	500
	6,3 x 25	E16	15	4005674 53147 4 000332V020-0630252-1	100
	6,3 x 32	E16	22	4005674 42503 2 000332V020-0630326-1	500
	6,3 x 32	E16	22	4005674 53148 1 000332V020-0630322-1	100
	6,3 x 38	E16	28	4005674 42504 9 000332V020-0630386-1	500
	6,3 x 38	E16	28	4005674 53149 8 000332V020-0630382-1	100

### Please note:

Also available with E19 sealing washer on request.

As a matter of principle, please pay attention to the data as specified in the technical approval Z-14.1-4, appendix 4.23 and Z-14.4-407, appendix 3.5 and Z-14.1-537, appendix 4.1.11/4.2.11

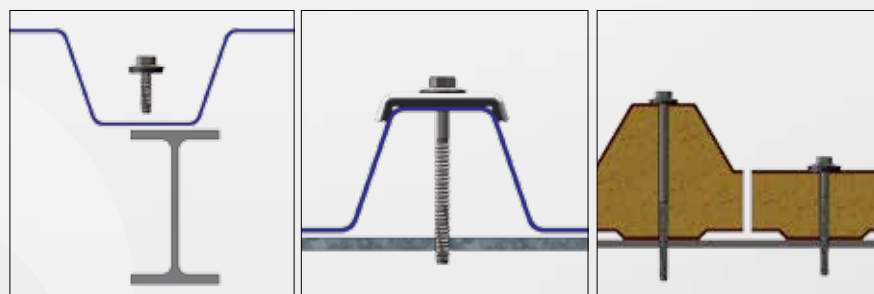

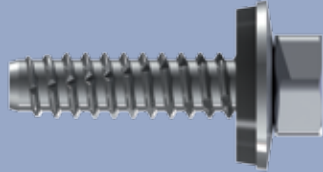

## Facade screw type BZ Stainless steel A2 FABA-BZ-6,3 x L E16

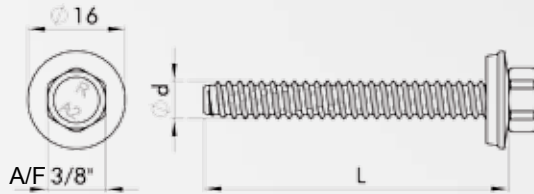

- Pre-drilling according to pre-drill table on page 73
- With technical approval
- Zinc-slide coating
- With captive sealing washer stainless steel A2/EPDM
- For steel substructure 1,25 mm and aluminium 1,5 mm

Designation	Ø d x L mm	Washer EPDM Ø	Grip thickness mm	EAN Item No.	Pack
FABA-BZ-	6,3 x 45	E16	35	4005674 42505 6 000332V020-063045E-1	300
	6,3 x 45	E16	35	4005674 47426 9 000332V020-0630452-1	100
	6,3 x 50	E16	40	4005674 42506 3 000332V020-063050E-1	300
	6,3 x 50	E16	40	4005674 41586 6 000332V020-0630502-1	100
	6,3 x 64	E16	54	4005674 42507 0 000332V020-063064E-1	300
	6,3 x 64	E16	54	4005674 40491 4 000332V020-0630642-1	100
	6,3 x 75	E16	65	4005674 42508 7 000332V020-063075E-1	300
	6,3 x 75	E16	65	4005674 41210 0 000332V020-0630752-1	100

### Please note:

Also available with E19 sealing washer on request.

As a matter of principle, please pay attention to the data as specified in the technical approval Z-14.1-4, appendix 4.23 and Z-14.4-407, appendix 3.5 and Z-14.1-537, appendix 4.1.11/4.2.11



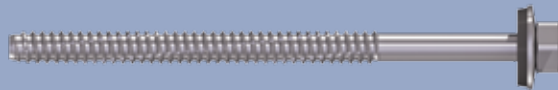

## Facade screw type BZ Stainless steel A2 FABA-BZ-6,3 x L E16

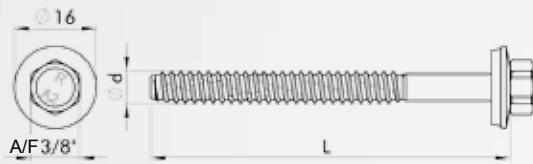

- Pre-drilling according to pre-drill table on page 73
- With technical approval
- Zinc-slide coating
- Length of partial thread 70 mm
- With captive sealing washer stainless steel A2/EPDM
- For steel substructure 1,25 mm and aluminium 1,5 mm

Designation	Ø d x L mm	Washer EPDM Ø	Grip thickness mm	EAN Item No.	Pack
FABA-BZ	6,3 x 90	E16	25-80	4005674 43498 0 000332V020-0630902-1	100
	6,3 x 100	E16	35-90	4005674 42180 5 000332V020-0631002-1	100
	6,3 x 115	E16	50-105	4005674 42673 2 000332V020-0631152-1	100
	6,3 x 130	E16	65-120	4005674 43383 9 000332V020-0631302-1	100
	6,3 x 150	E16	85-140	4005674 44194 0 000332V020-0631502-1	100
	6,3 x 175	E16	110-165	4005674 55063 5 000332V020-0631752-1	100
	6,3 x 200	E16	135-190	4005674 58709 9 000332V020-0632002-1	100

### Please note:

Also available with E19 sealing washer on request.

As a matter of principle, please pay attention to the data as specified in the technical approval Z-14.1-4, appendix 4.23 and Z-14.4-407, appendix 3.5 and Z-14.1-537, appendix 4.1.11/4.2.11



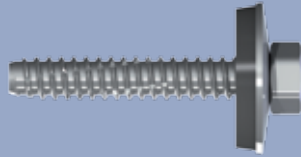

## Facade screw type BZ Stainless steel A2 FABA-BZ-6,3 x L E22

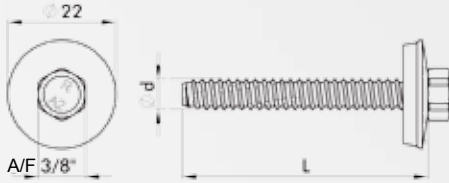

- Pre-drilling according to pre-drill table on page 73
- With technical approval
- Zinc-slide coating
- With captive sealing washer stainless steel A2/EPDM
- For steel substructure 1,25 mm and aluminium 1,5 mm

Bezeichnung	Ø d x L mm	Scheibe EPDM Ø	Klemmdicke mm	EAN Art. Nr.	VP
FABA-BZ	6,3 x 19	E22	9	4005674 58734 1 002332V020-0630192-1	100
	6,3 x 25	E22	15	4005674 58736 5 002332V020-0630252-1	100
	6,3 x 32	E22	22	4005674 58738 9 002332V020-0630322-1	100
	6,3 x 38	E22	28	4005674 58740 2 002332V020-0630382-1	100
	6,3 x 45	E22	35	4005674 58742 6 002332V020-0630452-1	100
	6,3 x 50	E22	40	4005674 58763 1 002332V020-0630502-1	100
	6,3 x 64	E22	54	4005674 58765 5 002332V020-0630642-1	100
	6,3 x 75	E22	65	4005674 58767 9 002332V020-0630752-1	100

### Please note:

Also available with E19 sealing washer on request.

As a matter of principle, please pay attention to the data as specified in the technical approval Z-14.1-4, appendix 4.23 and Z-14.4-407, appendix 3.5 and Z-14.1-537, appendix 4.1.11/4.2.11



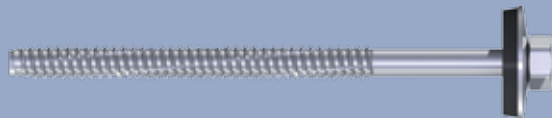

## Facade screw type BZ Stainless steel A2 FABA-BZ-6,3 x L E22



- Pre-drilling according to pre-drill table on page 73
- With technical approval
- Zinc-slide coating
- Length of the partial thread 70 mm
- With captive sealing washer stainless steel A2/EPDM
- For steel substructure 1,25 mm and aluminium 1,5 mm

Designation	Ø d x L mm	Washer EPDM Ø	Grip thickness mm	EAN Item No.	Pack
FABA-BZ	6,3 x 90	E22	25-80	4005674 58769 3 002332V020-0630902-1	100
	6,3 x 100	E22	35-90	4005674 58772 3 002332V020-0631002-1	100
	6,3 x 115	E22	50-105	4005674 46572 4 002332V020-0631152-1	100
	6,3 x 130	E22	65-120	4005674 47407 8 002332V020-0631302-1	100
	6,3 x 150	E22	85-140	4005674 46354 6 002332V020-0631502-1	100
	6,3 x 175	E22	110-165	4005674 47748 2 002332V020-0631752-1	100
	6,3 x 200	E22	135-190	4005674 47749 9 002332V020-0632002-1	100

### Please note:

Also available with E19 sealing washer on request.

As a matter of principle, please pay attention to the data as specified in the technical approval Z-14.1-4, appendix 4.23 and Z-14.4-407, appendix 3.5 and Z-14.1-537, appendix 4.1.11/4.2.11

