

You catch
the sun,
we hold it

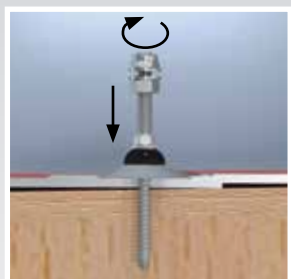
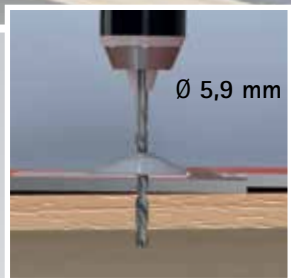
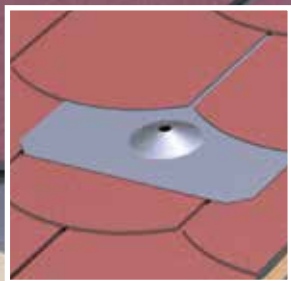
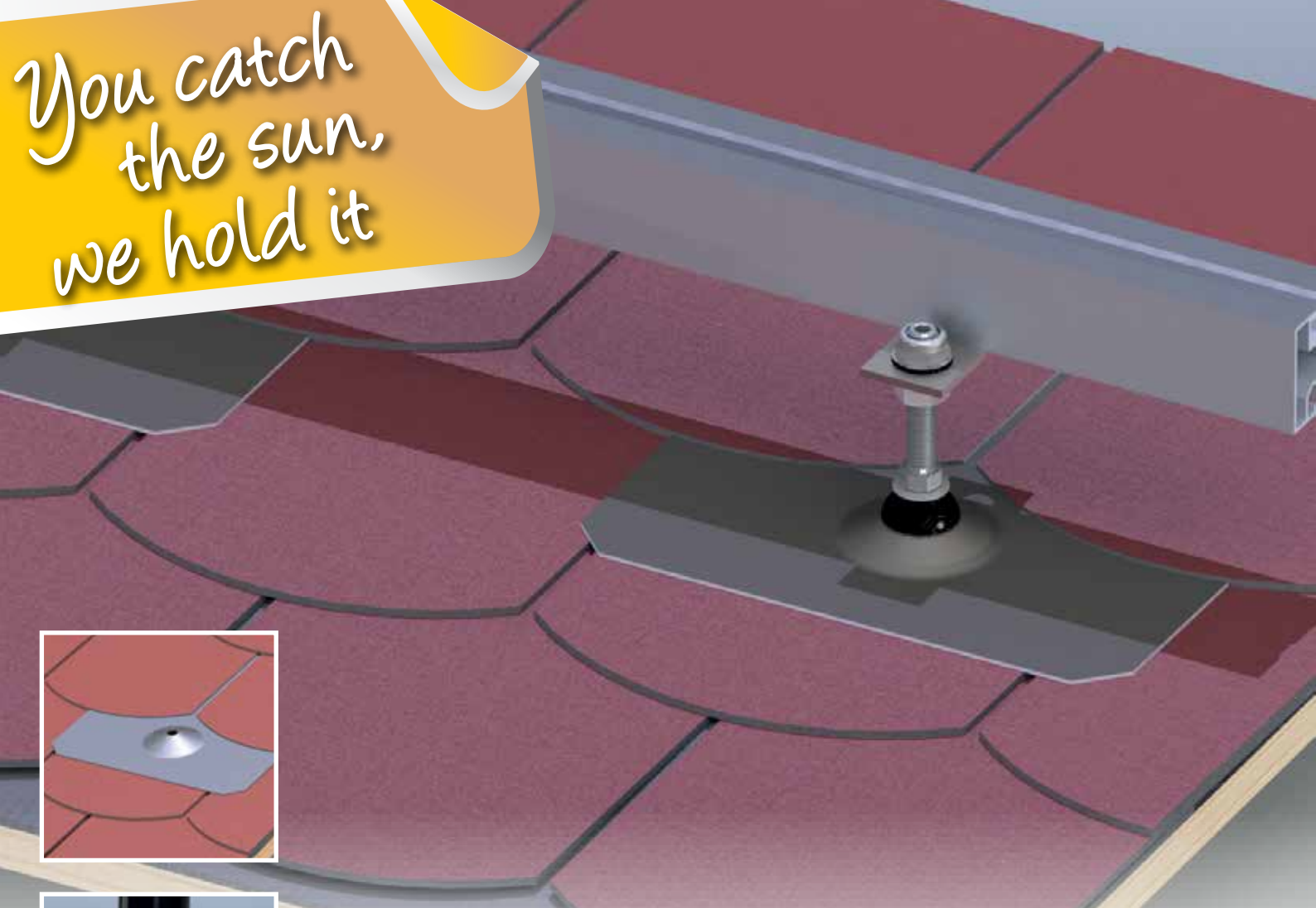

REISSER

Mounting solar panels on shingle roofs

- Quick, waterproof shingle roof connection in four steps
- Appropriate for all shingle roofs
- No accumulation of dirt
- With technical approval



REISSER-Schraubentechnik GmbH
Fritz-Müller-Str. 10 • D-74653 Ingelfingen-Criesbach
Fon: +49 7940/127-160 • Fax: +49 7940/127-123
produktion@reisser-screws.com • www.reisser-screws.com

REISSER
SCHRAUBENTECHNIK



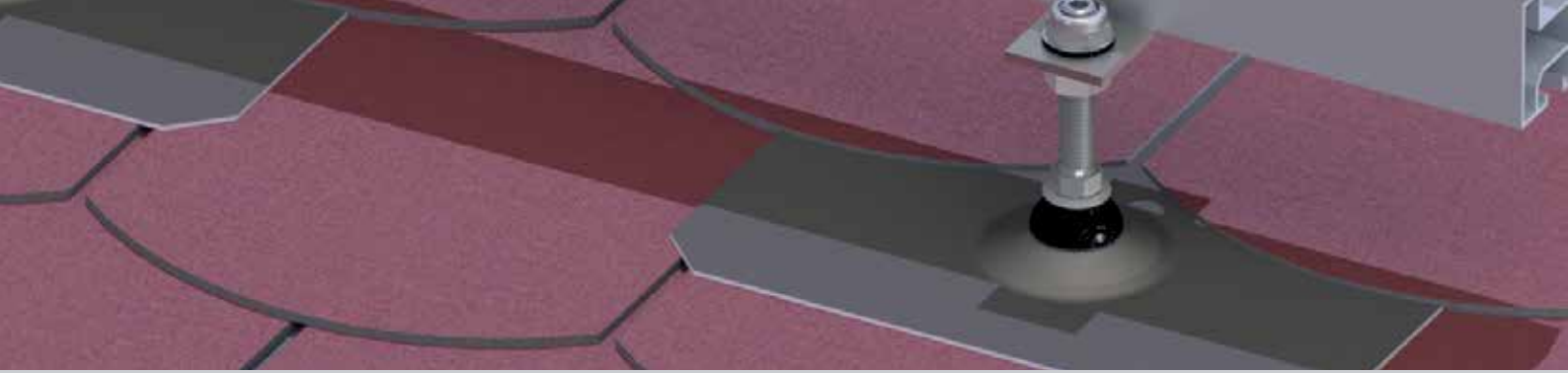

REISSER Mounting solar panels on shingle roofs

To mount solar panels, a solar fastener is screwed into the substructure/rafters. The solar panel's substructure can then be attached to the fastener. To prevent any water penetrating at the solar fastener's pre-drilled location, a generously sized covering must be attached around the hole. For this purpose, a piece of sheet metal of similar size to the shingles is inserted between the individual layers of shingles. This sheet is positioned so that it lies directly above the rafters. An initial pilot hole is drilled in the rafters through the elevated hole, and the REISSER solar fastener is then screwed on. When tightening the solar fastener, the two sealing elements must be in close contact to one other (but do not cut into each other) to ensure that the screw connection is perfectly sealed.

The elevated sheet metal component, which raises the REISSER solar fastener above the water-carrying level, lies on the row of shingles through which the screws pass, and it is then inserted into the row of shingles below. This way, inflowing water runs off, just as it flows off all the other surface areas of the shingle roof.

This principle also applies on slate and artificial slate or on sheet metal shingle and bitumen shingle roofs. A solar panel system can be mounted very economically and technically approved on these types of roofs with the aid of these two components.

Solar shingle set consisting of:

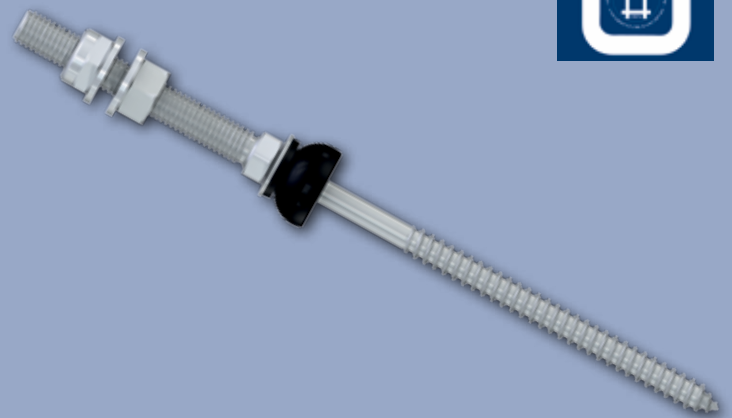

1. Sheet aluminium component
of the appropriate size
(l x w mm: 580 x 250, 380 x 280, 246 x 205)

2. REISSER solar fastener type A 8,4/M10 x 130-180
with E19 sealing washer and SD24 umbrella sealing

Accessory for pre-drilling: high profile drill, HSS 5,9x200 (item no. T338 S 011 059 200 D)

